

# **INDUSTRIAL DOOR OPERATOR USER'S MANUAL**

## **WARNING!**

**ONLY QUALIFIED AND EXPERIENCED TECHNICIANS  
SHOULD ATTEMPT INSTALLATION OR SERVICE TO THIS  
UNIT, OTHERWISE, SERIOUS PERSONAL INJURY,  
DEATH, OR PROPERTY DAMAGE MAY OCCUR.**

**PLEASE KEEP THESE INSTRUCTIONS FOR FURTHER  
REFERENCE.**

## OUTLINE

1. Safety instructions .....	2
2. Main function .....	2
3. Main technical parameters .....	3
4. Tools required .....	3
5. Dimension .....	3
6. Installation .....	4
7. Manual operation and release function .....	7
8. Wiring .....	9
9. Adjustment and programming .....	13
10. Maintenance .....	16
11. Troubleshooting .....	16
12. Packing list .....	17

## 1. Safety instructions



It is important that you read all the following instruction:

- Read carefully this manual.
- The door operator should be installed and put into operation by qualified personnel. Otherwise, serious personal injury or property damage may occur.
- The door must be equipped with balance springs, otherwise the operator will be damaged. Before installation of the door operator, the door should be carefully checked for being kept well balance. The door must be in good working order.
- It is necessary to install the mechanical stops on guides, in order to avoid the exit of the door from the guides.
- The operator motor may only be disengaged with the door closed. This must be carried out by specialist personnel for maintenance purpose only.
- Locate any fixed control: within sight of door but away from all moving parts of the door and at a height of more than 1.4m above the ground to avoid children reaching it. Keep remote controls or button switch away from children, to prevent the door operator from being activated involuntarily.
- The operator should be switched off before repairing it or opening its cover.
- When opening or closing the door, do not attempt to walk or drive through the door.
- The door should only be operated when it can be observed to avoid accidents.
- Do not pull the hand chain during opening or closing the door electrically.
- Permanently fix the safety labels against equipment in a prominent place or near any fixed controls.
- Our company reserves the right to change the design and specification without prior notification.

## 2. Main function

- Three buttons (open, close, stop) on the control unit control the door separately. The control system is fitted with wiring terminals for photocell, safety edge, wicket door , open priority etc..
- Remote control: hopping code technology prevents thieves from guessing your remote code. Up to 25 remote controls may be used.
- Emergency stop: In an emergency, press the emergency button can cut off the power of control unit immediately.
- Auto brake system: it makes the motor stop fast and accurately.
- Rotate the release handle 180° anticlockwise, release the door from the door operator immediately. The operator motor may only be disengaged with the door closed.
- In the event of power failure, a release hand chain allows you to operate the door manually.
- It has double limit switches to ensure the operator safety and reliability.
- Chain box can be rotated 360° .

### 3. Main technical parameters

Model	KG50-8	KG50S-8	KG75-8	KG75S-8	KG40-8	KG70S-8
Power supply	AC220V	AC380V	AC220V	AC380V	AC220V	AC380V
Max. output torque	30N.m	50N.m	40N.m	75N.m	40N.m	70N.m
Rotation speed	32rpm	32rpm	24rpm	24rpm	24rpm	24rpm
Motor power	300W	400W	300W	400W	300W	400W
Door	$\leq 18\text{m}^2$	$\leq 25\text{m}^2$	$\leq 20\text{m}^2$	$\leq 30\text{m}^2$	$\leq 20\text{m}^2$	$\leq 30\text{m}^2$
Output shaft aperture	25.4 mm					
Max. limit switch travel	Output shaft rotates 40 circuits					
Environment temperature	$-20^{\circ}\text{C} \sim +45^{\circ}\text{C}$					
Work duty	S2, 20% (continuous working time no more than 10min)					

### 4. Tools required

- Spanners
- Slotted and cross screwdrivers
- Electric drill
- Pliers
- Hacksaw
- Tape measure

Use a helper if possible to assist with the installation.

### 5. Dimension

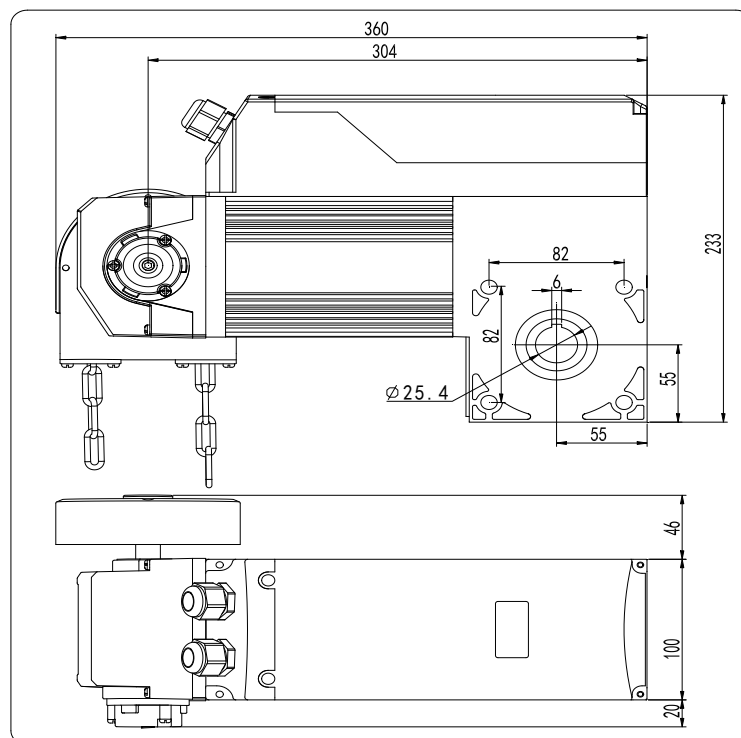

Fig.1

## 6. Installation

Before installing, make sure the door is in good working condition and torsion springs balance its leaf. We advise to install the operator as described below see '**on-shaft mounting**' section or '**mounting via chain drive**' section.

### On-shaft mounting

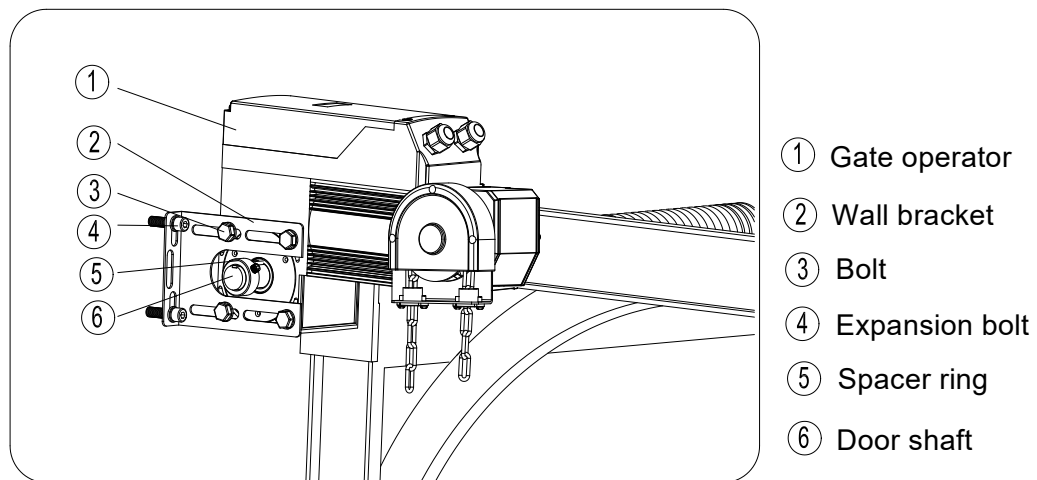

Fig.2

### Mounting via chain drive

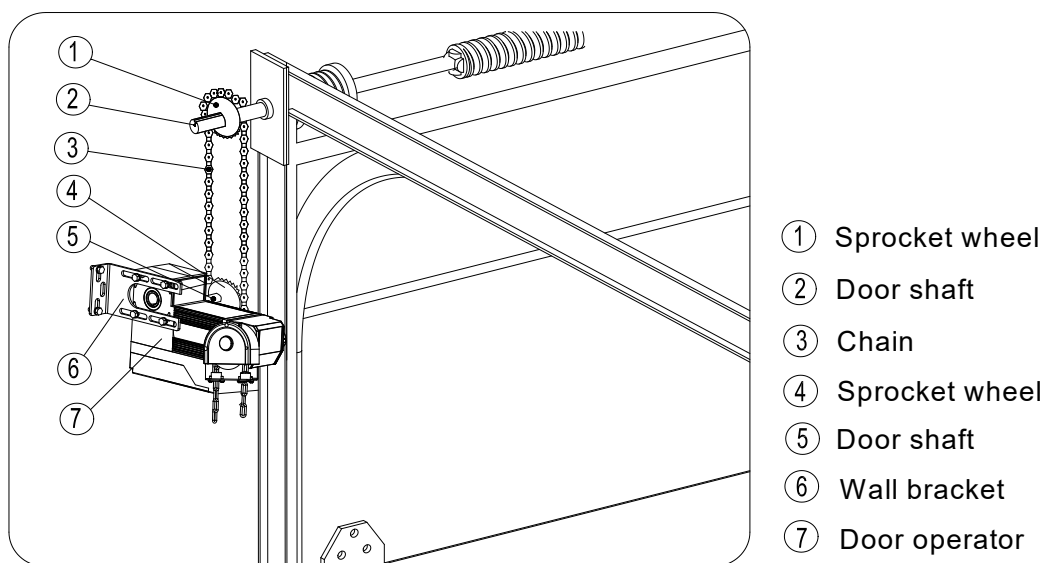

Fig.3

### **Door adjustment**

Adjust the torsion spring of the door before installing the door opener. manually open and close the door smoothly .

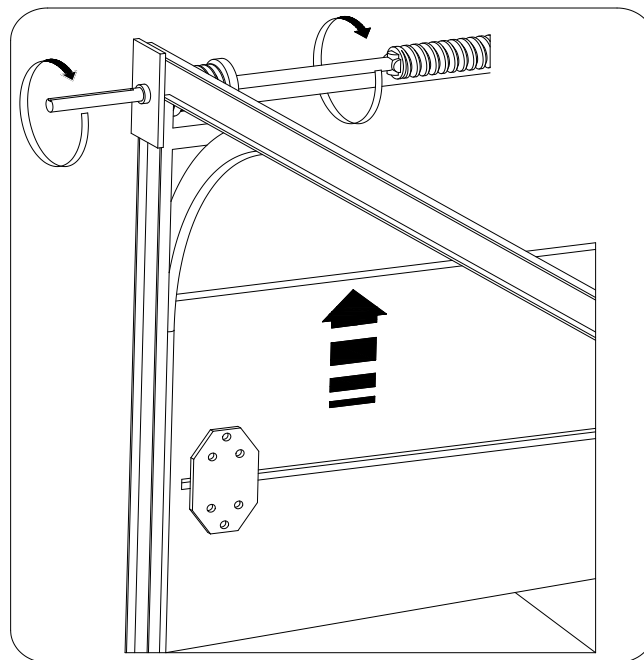
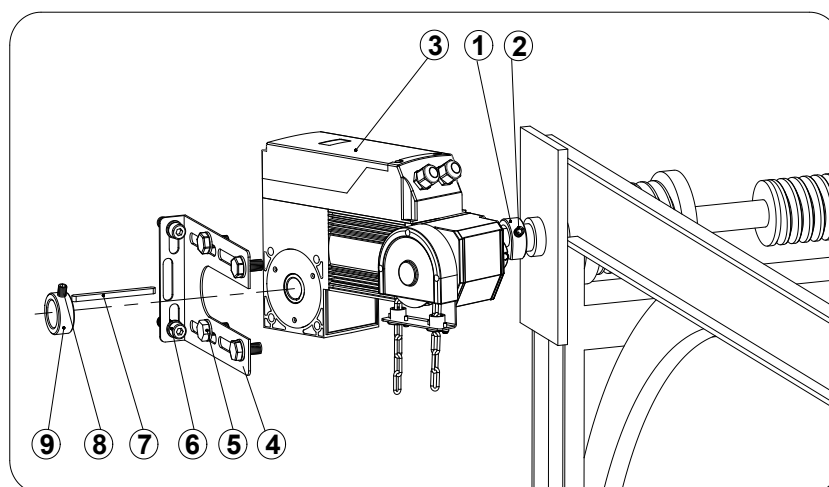

Fig.4



- ① The 1st spacer ring
- ② Screw
- ③ Gate operator
- ④ Wall bracket
- ⑤ Bolt
- ⑥ Expansion bolt
- ⑦ Key
- ⑧ Screw
- ⑨ The 2nd spacer ring

Fig.5

### **On-shaft mounting**

- Slot the door operator onto the door shaft, check the mounting position of the wall bracket, Mark the line on the wall using a pencil.
- Remove the door operator.
- Fix the expansion bolt anchor on the wall.
- Slot the 1st spacer ring ① onto the door shaft, tighten the screw ②.
- Slot the door operator back onto the door shaft (ensure correct position of the key⑦) and screw the wall bracket (L-shaped iron fitting)④ on the operator ③ with four bolts M10×20 ⑤ and plain washers.

- Mount the wall bracket ④ onto the wall using expansion bolt⑥. The wall bracket can be placed from the left or from the right of the operator.
- Slot the 2nd spacer ring ⑨ onto the door shaft and push it close to the door operator. Push the 1st spacer ring close to the operator and fix both rings with two screws M8×15.

The boom gate is normally delivered in right side(see Fig.7A), if you need to change it from right side to left side(see Fig.7 B) proceed as follows:

- Loose the four screws⑥, remove the plastic cover⑤.
- loose the hexagon socket screws③.
- Pull out wire from the terminal block②.
- Turn the base 180° ①.
- Connect the limit switch and terminal block to the other side.
- Reconnect the wire.

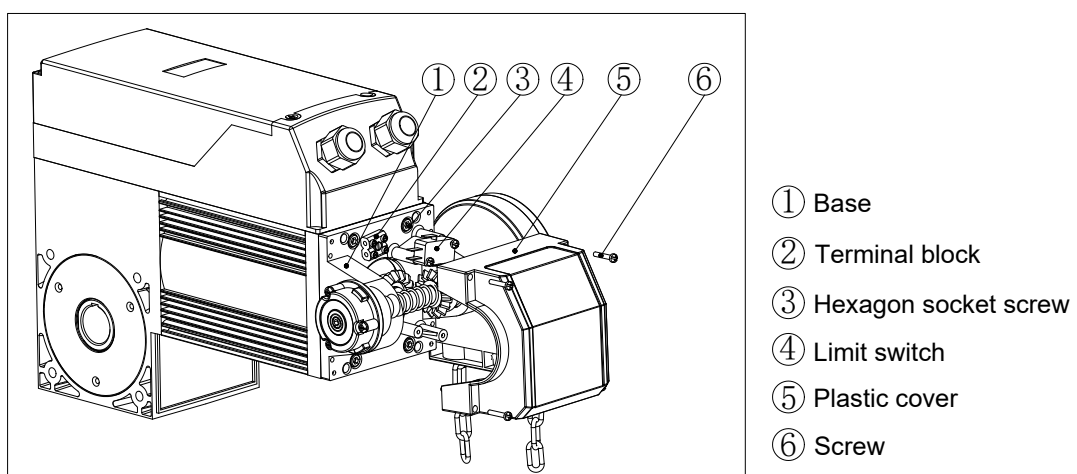

Fig.6

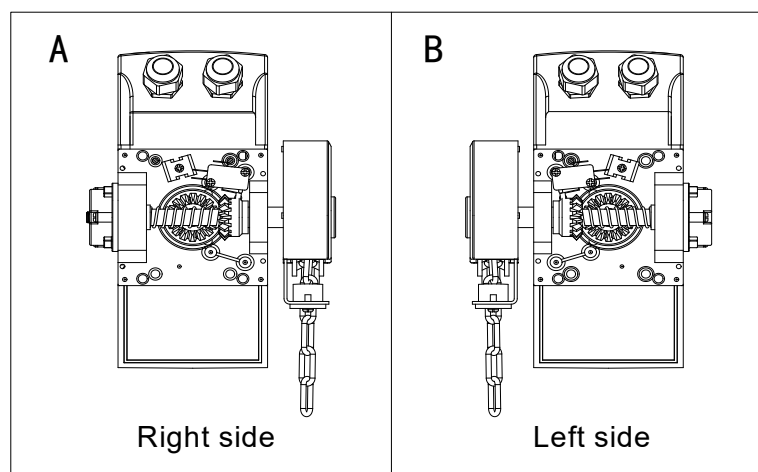

Fig.7

**Information:**

The optional accessories are not included in the standard package, they can be purchased separately.

Before installing, make sure that the space available above the door are suitable, it is recommended that you should better install the operator as shown in fig.8 ( I ).

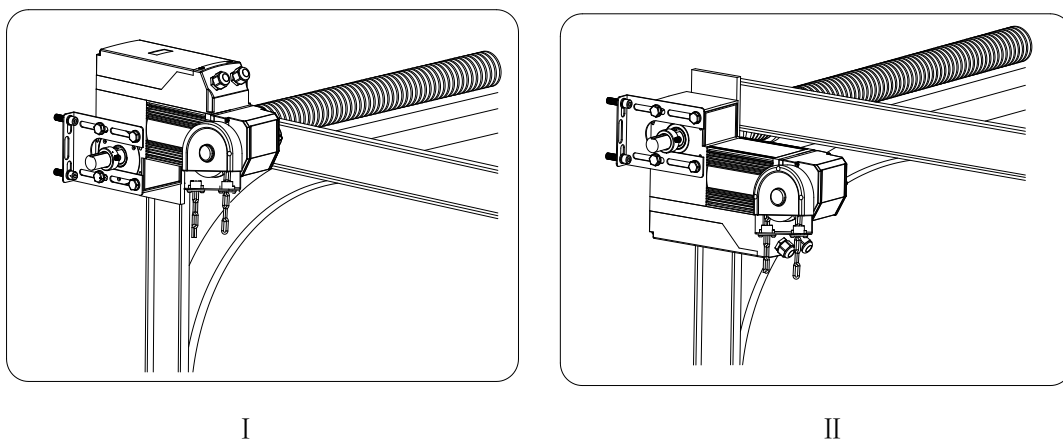

Fig.8

## 7. Manual operation and release function

### Manual operation

The operator is equipped with a manual chain, which is used for lifting/lowering of the door in case of power cut.

### Operation with hand chain

In case of power failure, move the door in the OPEN or CLOSE direction by pulling on the hand chain.

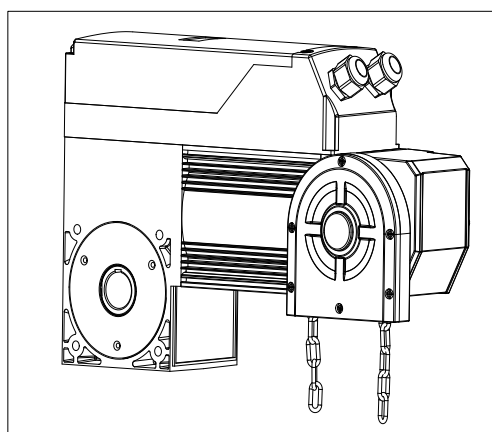

Fig.9 Operation with hand chain

The gate fails to move if pull the release chain, rotate the bolt clockwise by hex wrench see Fig.10.



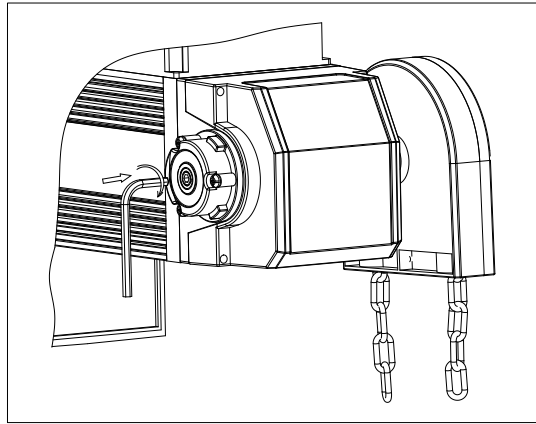

Fig.10

**Information:**

If the operator does not work electrically, pull one side of hand chain lightly until a reset is carried out see Fig.11 (1), the light turns off, now the electronic control unit can be used.

**Warning:**

- Intensive and continuous use of the hand chain is forbidden, it may be used only in emergency.
- Do not pull the chain too hard, otherwise the chain components will be damaged.
- It is important to ensure that the chain is not fitted twisted. If the chain is twisted, malfunctions may occur when the hand chain is used.
- It is recommended to fix the lower part of the chain as shown in Fig.11 (2), to avoid hindrance to people and equipment move.

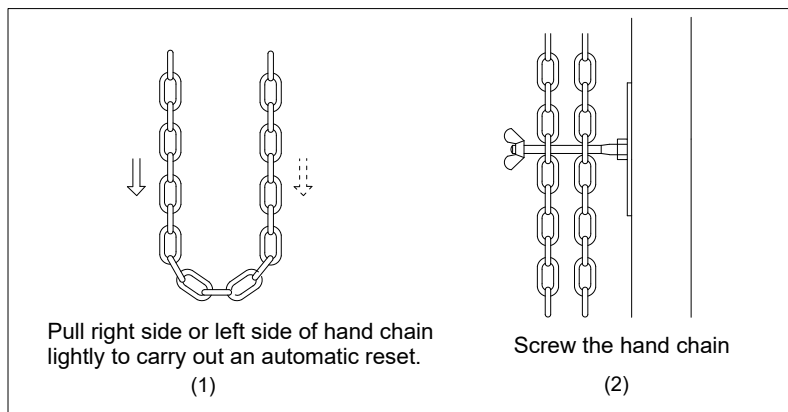

Fig.11

**Release function**

- Remove the plastic housing.
- Rotate the release handle by 180 degrees anticlockwise, release the door operator.
- Rotate the release handle by 180 degrees clockwise, engage the door operator.

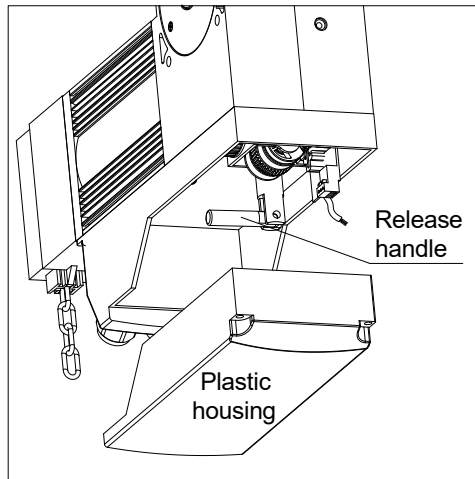

Fig.12

## 8. Wiring



Before carry out any wiring work, it is essential to disconnect the control unit from the mains supply.

- Locate control unit: within sight of door but away from all moving parts of the door and at a height of more than 1.4m above the ground to avoid children reaching it.
- Feed the cables through the screw fitting into the operator, connect all the cables required.
- Connect the cables to control unit in the same color. See **wiring chart**
- Wires within the cable shall be protected so that no damage can result from contact with any rough, sharp part. In order to protect electrical elements from water, waterproof screw fitting must be tightened by turning the plastic nut.
- In an emergency, press the red emergency switch on the control unit can cut off the power of control unit immediately. Rotate the switch in arrow direction to make the switch return to its original position.

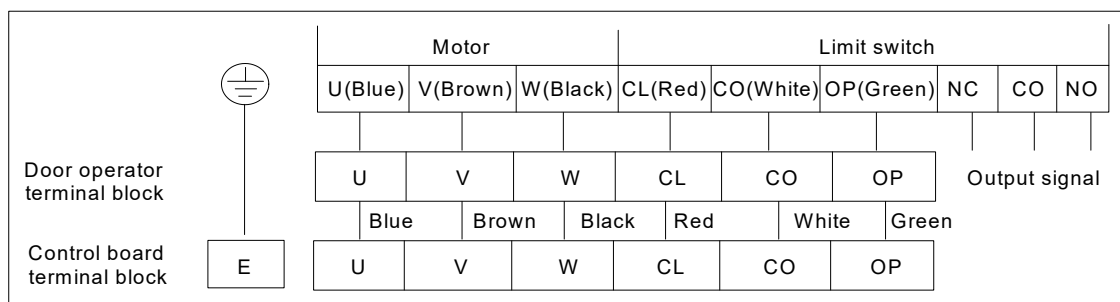

Fig.13 Wiring chart

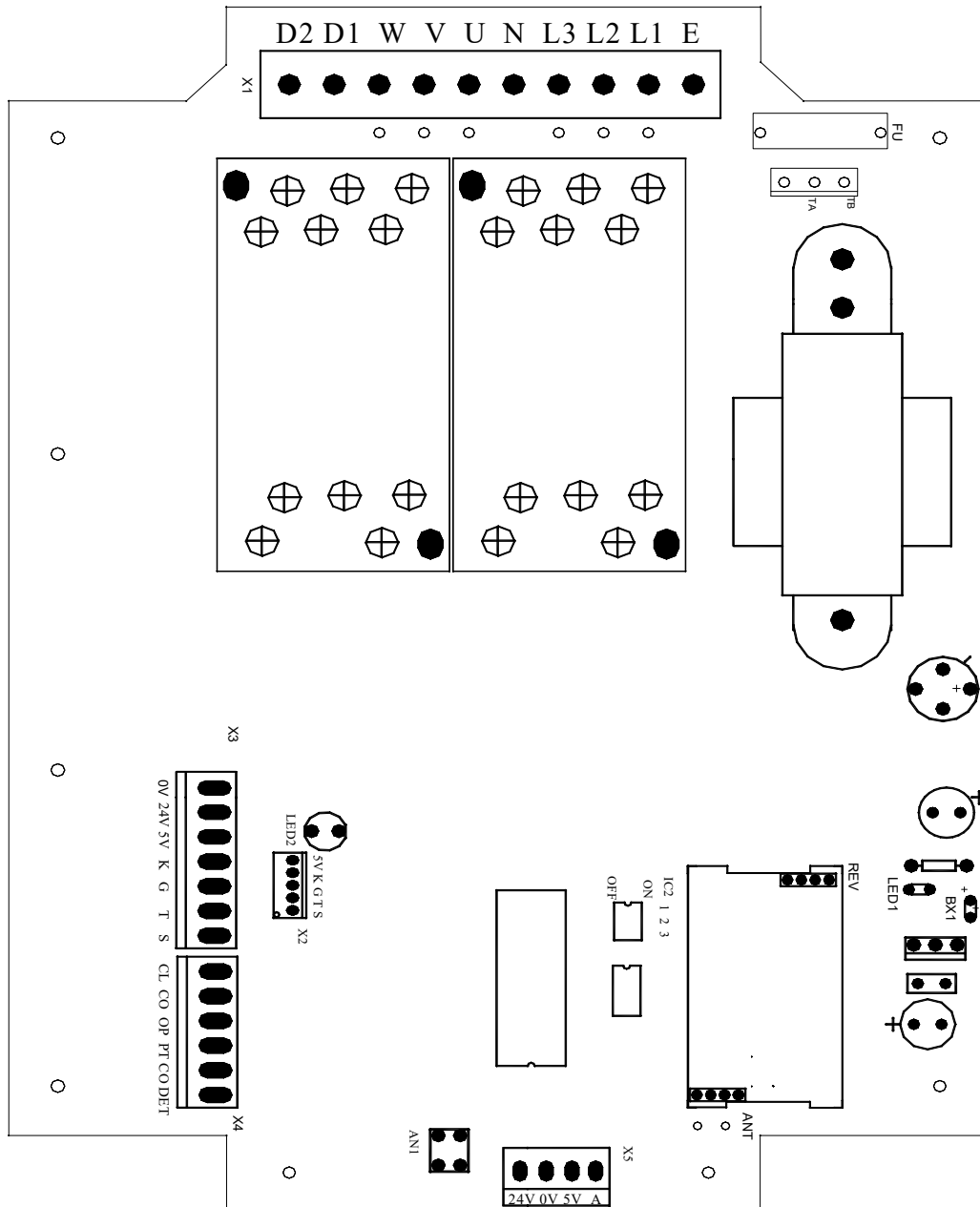

Fig.14 Three-phase control board diagram

**Three phase control board see Fig.14**

- Connect phase wires (380V) to 'L1', 'L2', 'L3'. Connect neutral wire to 'N', connect ground wire to 'E'. See terminal X1  
Note: turn the power on, if the 'LED2' is flashing, disconnect from mains supply, then reverse any two phase wires.
- Connect motor wire (blue, brown, black) to 'U', 'V', 'W', ground wire to 'E'. If door running direction is wrong, please exchange wires 'U' and 'V'. See terminal X1
- D1, D2: alarm lamp(AC220V). See terminal X1
- Connect close limit wire (red) to 'CL', connect common wire (white) to 'CO', connect open limit wire (green) to 'OP'. See terminal X4

- Connect signal wires of photocell (N.O.) to 'PT' and 'CO', power wires to '24V' and '0V'. See terminal X3 and X4
- Connect safety edge switch wires to 'PT' and 'CO'. See terminal X4
- Connect loop detector (N.C.) wires to 'DET' and 'CO', if connected, the short bridge must be removed. See terminal X4
- Connect external button switch (N.O.) to 'K', 'G', 'T' and 'S'. K-open (white), G-close (yellow), T-stop (red), S-common wire (green). See terminal X3

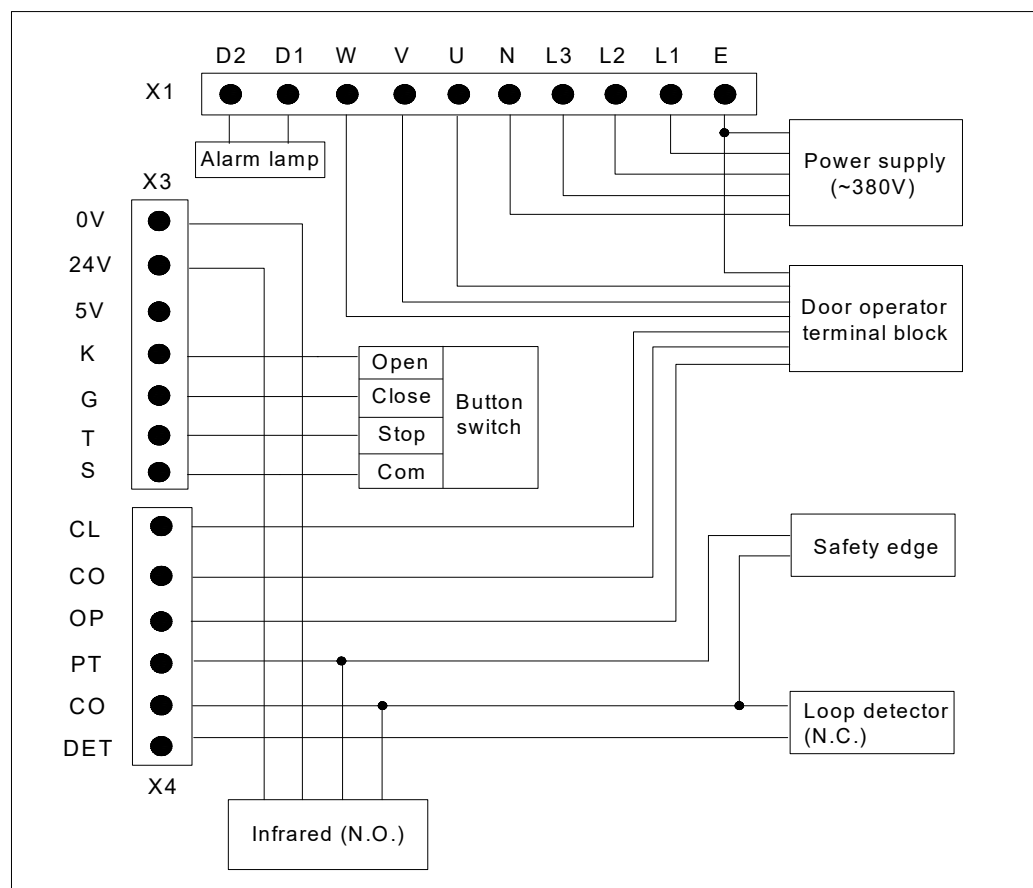

Fig.15

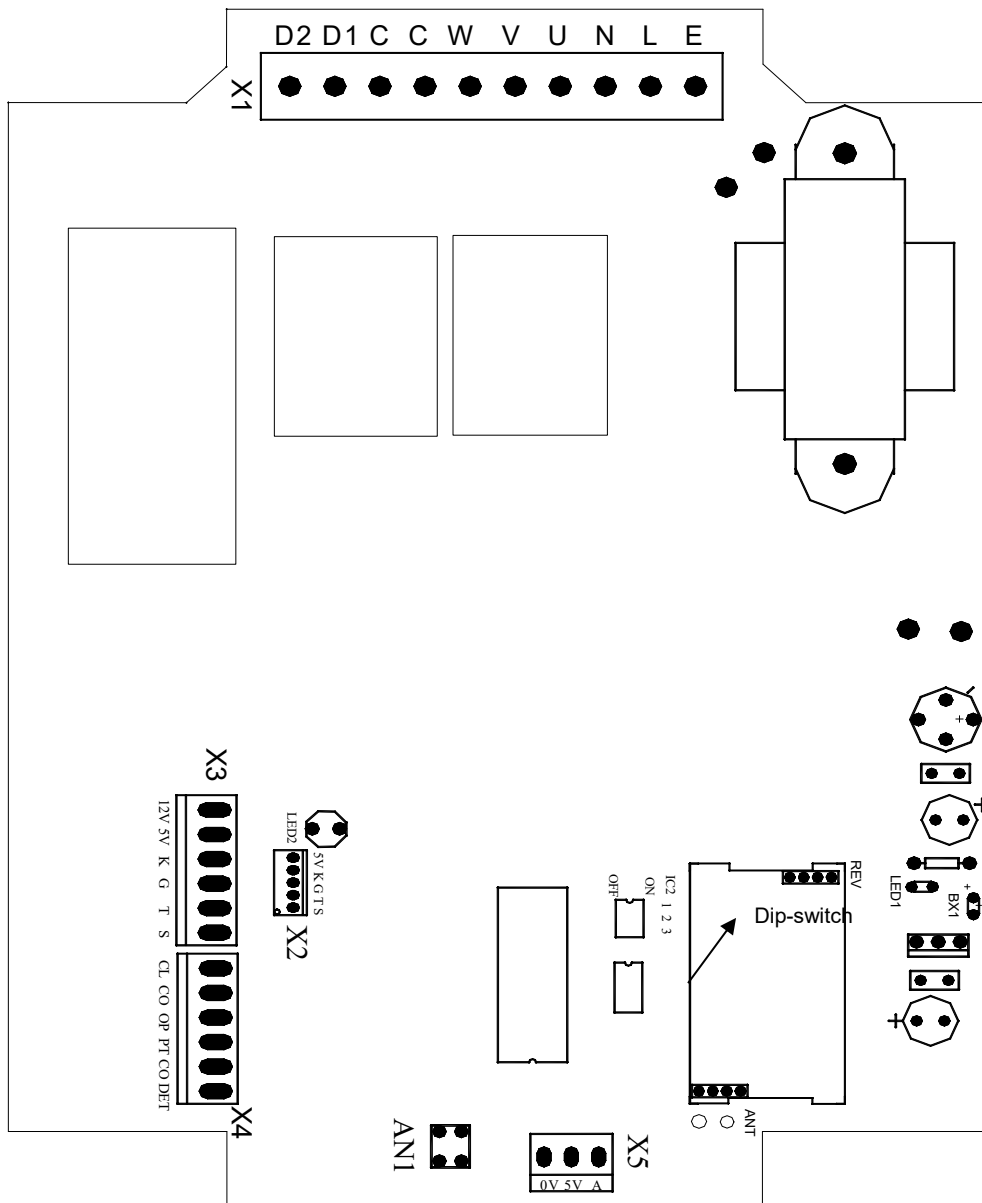

Fig.16 Single phase control board diagram

**Single phase control board see Fig.16**

- Connect power wires (220V) to 'L'. Connect neutral wire to 'N', connect ground wire to 'E'.
- Connect motor wire (blue, brown, black) to 'U', 'V', 'W'. If door running direction is wrong, please exchange wires 'V' and 'W'. See terminal X1
- D1,D2: alarm lamp(AC220V). See terminal X1
- Connect close limit wire (red) to 'CL', connect common wire (white) to 'CO', connect open limit wire (green) to 'OP'. See terminal X4
- Connect signal wires of photocell (N.O.) to 'PT' and 'CO' and power wires to '12V' and 'S'. See terminal X3 and X4
- Connect safety edge switch wires to 'PT' and 'CO'. See terminal X4

- Connect loop detector (N.C.) wires to 'DET' and 'CO', if connected, the short bridge must be removed. See terminal X4
- Connect external button switch (N.O.) to 'K', 'G', 'T' and 'S'. K-open (white), G-close (yellow), T-stop (red), S-common wire (green). See terminal X3

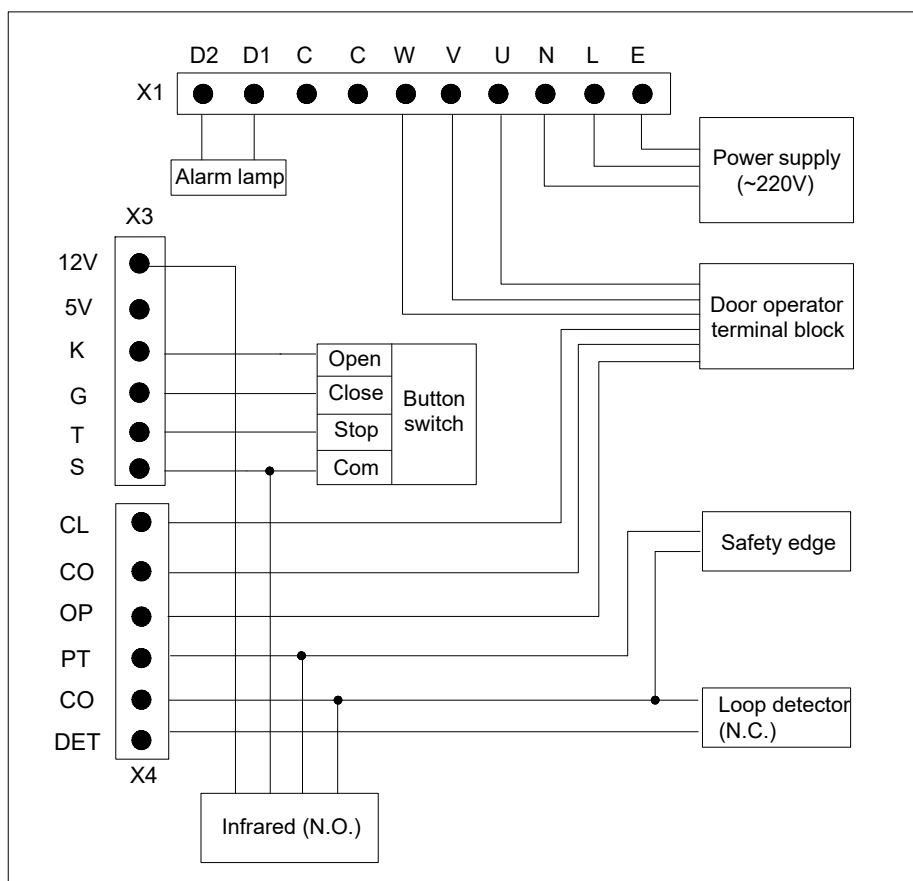

Fig.17

## 9. Adjustment and programming

### (1) DIP- switch

Position	ON	OFF
1	Auto-close enable	Auto-close disable
2	Infrared photocell N.C.(auto-close disable)	Infrared photocell N.O.
3	Auto-close time delay: 9 seconds Note: DIP-switch 1 must be set ON.	Auto-close time delay: 27 seconds Note: DIP-switch 1 must be set ON.

**(2) Limit switch**

Below are all of the available limit switches for door operators, the limit switch came with your operator depends on your order. You may select limit switch (I or II) according to your needs.

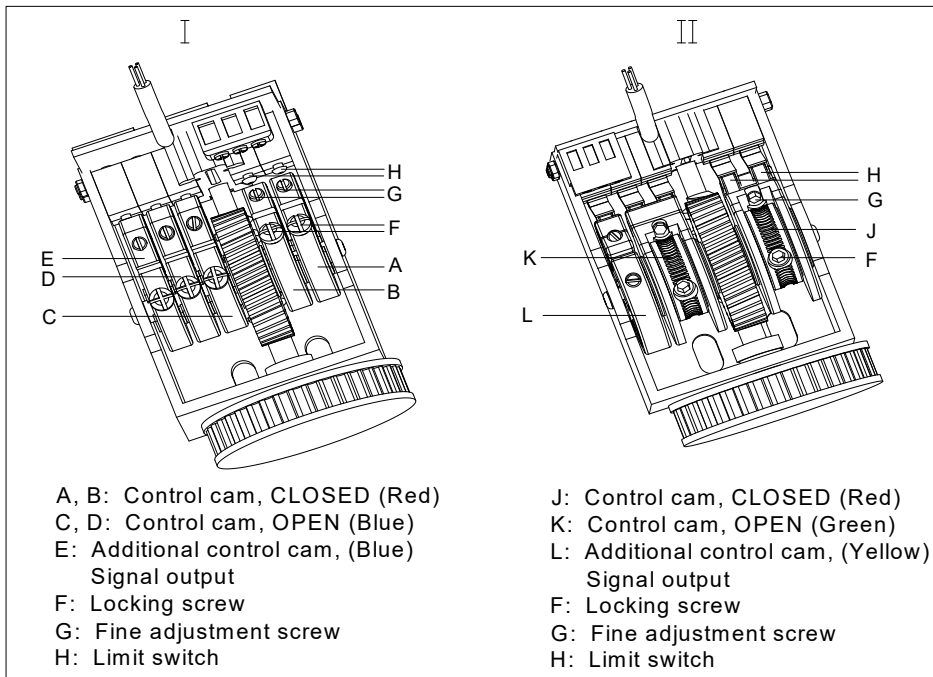

Fig.18

**Information:**

Each control cam has a locking screw (F) and a fine adjustment screw (G).

The locking screw is used to lock the corresponding control cam in the desired position. Fine adjustment can be made with the fine adjustment screw.

**Set the CLOSED end position****Rough adjusting**

- Make sure that the operator is fixed rigidly.
- Loose the locking screws (F) of red cams.
- Drive the door to the CLOSED end position, observe the rotating direction of red control cams (I- A B, II - J) during closing.
- Turn the red cams (I- A B, II - J) in the same direction until the limit switches (H) click.
- Finally tighten the locking screws.
- Repeat this step until the door is less than 20-30mm from the closed position.

**Fine adjusting**

- After rough adjustment, you can close the door and observe whether the door has successfully reached the closed position.
- If the door does not reach the fully closed position (less than 20-30mm), adjust the fine adjustment screws (G) in the red control cams carefully to make the door reach the closed position, anticlockwise to close more, clockwise to close less.

**Set the OPEN end position****Rough adjusting**

- Loose the locking screws.
- Drive the door to the OPEN end position, observe the rotating direction of the two blue control cams or green control cam (I- C D, II - K) during opening.
- Turn them in the same direction (i.e. on the opposite direction of the red cam) until the limit switches click.
- Finally tighten the locking screws.

**Fine adjusting**

- If the door does not reach the fully open position (less than 20-30mm), adjust the fine adjustment screws in the two blue control cams (or green control cam), anticlockwise to open more, clockwise to open less.

**Information:**

When the door reaches fully closed or open position, make sure that the limit switches are active and the indicator on the control unit shall dim out. If the indicator does not dim out, repeat adjustment.



**Warning:** Please use the control unit to adjust the end positions, DO NOT use remote control.

**(3) Adding / erase remote controls**

- **Adding extra remote controls (Learn):** Press the button 'AN1' on the control board, the 'LED1' will be on and then turn off. Press any remote control button, the 'LED1' will be on and then turn off. Press the same remote control button again, the 'LED1' will flash about 4 seconds at 1/2Hz frequency and then turn off, this indicates the learning process is finished.  
Up to 25 remote controls may be used.
- **To erase all remoter controls:** press and hold 'AN1' button on the control board, release the button once 'LED1' turns off automatically. This indicates that all the remote controls have been erased completely.
- The remote control came with your operator depends on your order. Additional remote controls can be purchased through your dealer. If you have any problem, please contact the dealer.
- The remote control works in three-channel mode, (1-open, 2-close, 3-stop, 4-not used)  
See Fig.19.

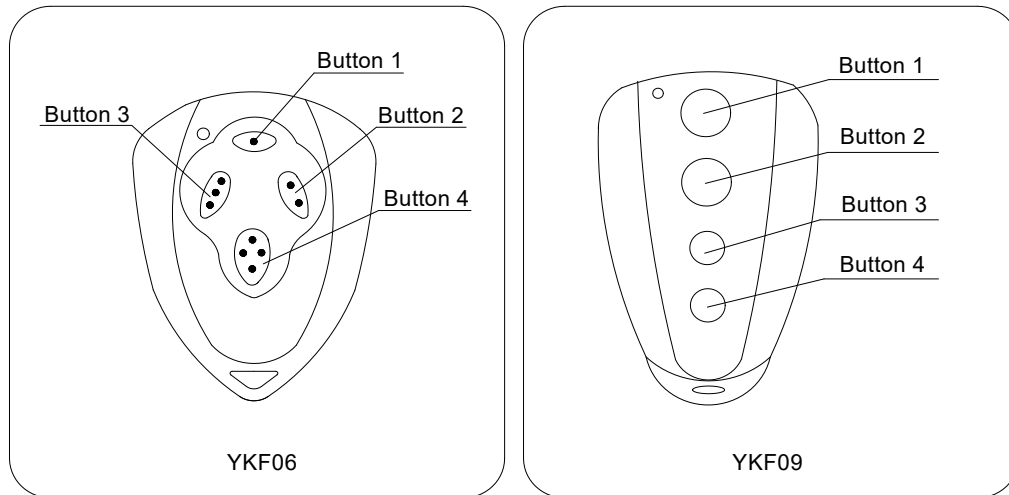

Fig.19



**Warning:** For safety and security, we recommend that the factory setting be replaced with a personal code.



## 10. Maintenance

- Make sure the door is in good working order and that is correctly balanced.
- Have qualified technicians to service this operator.
- Keep operator clean at all times.
- Our company reserves the right to change the design and specification without prior notification.

## 11. Troubleshooting

Error	Cause for error	Remedies
The operator will not work.	(1) Power is OFF. (2) The door is obstructed. (3)The wires become loose. (4)The emergency switch was pressed. (5)The release handle is disengaged.	(1) Make sure that power is ON. (2) Remove obstructions. (3) Fasten the wires. (4) Rotate the emergency switch to ensure that the button returns to its original position. (5) Engage the release handle.
After using the hand chain, the operator does not work after you press control unit button or transmitter.	An automatic reset is not carried out.	Pull the hand chain see Fig.11 (1) to carry out an automatic reset. (See <b>Hand chain</b> section)
The operator stops working suddenly.	Thermal overload protection in motor is active.	Allow the motor to cool down.
The door cannot be opened or closed fully.	Wrong adjusting of limit switch.	Readjust the limit switch.
Remote control does not work.	(1)Battery level may be low. (2)Remote control is not suitable for receiver. Wrong programming of remote control coding.	(1)Replace the battery inside the remote control. (2)Erase remote controls and then re-program the remote control.

## 12. Packing list

After receiving the product, you should make an unpack-inspection, in which you should check whether the product was damaged. If you have any problem please contact our sales agent. You should find the following items in our standard packing:

No.	Item	Quantity
1	Door operator	1
2	Wall bracket	1
3	Spacer ring	2
4	Screw (M8X15)	2
5	Key	1
6	Bolt (M10×20)	4
7	Plain washer	4
8	Cable (6m)	2
9	Hexagonal wrench key ( for II limit switch only )	1
10	Safety label	1
11	Remote control (optional)	2
12	Control unit	1
13	User's manual	1